

6411949	Residential	Single Family - Detached	Active
Beds/Baths: 5 / 8		Approx Lot SqFt: 255,196 / County Assessor	
Bedrooms Plus: 7		Approx Lot Acres: 5.858	
Approx SqFt: 7,629 / County Assessor		Subdivision: LOST CANYON	
Price/SqFt: \$766.81		Tax Municipality: Scottsdale	
Year Built: 2008		Marketing Name: Contemporary Lost Canyon	
Flood Zone: No		Planned Cmty Name: Lost Canyon	
Pool: Private Only		Model: Estate	
Encoded Features: 58FRDXPSO4G2C8S		Builder Name: Kitchell Custom	
Exterior Stories: 1		Hun Block:	
# of Interior Levels: 1		Map Code/Grid: J38	
Dwelling Type: Single Family - Detached		Building Number:	
Dwelling Styles: Detached		High School Dist #: 048 - Scottsdale Unified District	
Ele Sch Dist: 048 - Scottsdale Unified District		High School: Chaparral High School	
Elementary School: Copper Ridge Elementary School			
Jr. High School: Copper Ridge Middle School			

**Cross Streets:** Pinnacle Peak and Pima **Directions:** PIMA Rd: At Los Gatos light: head east t to Adobe, Rt; Left on 98th St; South (Rt) on Church; East (Rt) on Foothills Drive to Lost Canyon Gate. OR East on Pinnacle Peak, south on Church to Foothills D

**Public Remarks:** High soaring ceilings and walls of glass, angles, points and surprising curves depict the artistry of this modern single level hillside luxury home. Perched high on nearly 6 acres in coveted Lost Canyon, a large center courtyard allows operable walls of Floor-to-ceiling glass to encircle the living space from both the exterior and interior providing abundant daylighting and passive ventilation. Waterfall tumbling from suspended steel trusses over the negative edge pool and spa create an illusion of a natural mountain spring visible from every room with clear views into the Canyon. An open layout and gorgeous white Carrara Marble select honed 24x24 tile used throughout continues the transparency into the surrounding hillside. Premium York Affinity HVAC systems helped achieve green certifica

Features	Room Details	Construction & Utilities	County, Tax and Financing
<b>Garage Spaces:</b> 4 <b>Carport Spaces:</b> 2 <b>Total Covered Spaces:</b> 6 <b>Slab Parking Spaces:</b> 8 <b>Parking Features:</b> Attch'd Gar Cabinets; Dir Entry frm Garage; Electric Door Opener; Side Vehicle Entry <b>Road Responsibility:</b> Private Maintained Road <b>Pool Features:</b> Private; Heated <b>Spa:</b> Private; Heated <b>Horses:</b> N <b>Fireplace:</b> 3+ Fireplace; Fireplace Family Rm; Fireplace Living Rm; Fireplace Master Bdr; Two Way Fireplace; Gas Fireplace; Exterior Fireplace <b>Property Description:</b> Hillside Lot; City Light View(s); Mountain View(s) <b>Landscaping:</b> Desert Front; Desert Back <b>Exterior Features:</b> Patio; Covered Patio(s); Balcony; Gazebo/Ramada; Storage; Circular Drive; Private Street(s); Built-in BBQ <b>Features:</b> Skylight(s); Vaulted Ceiling(s); 9+ Flat Ceilings; Central Vacuum; Wet Bar; Elevator <b>Community Features:</b> Gated Community; Guarded Entry; On-Site Guard <b>Add'l Property Use:</b> None <b>Flooring:</b> Carpet; Stone; Tile; Wood <b>Windows:</b> Dual Pane; Mechanical Sun Shds	<b>Kitchen Features:</b> Gas Stub for Range; Disposal; Dishwasher; Built-in Microwave; Refrigerator; Reverse Osmosis; Built In Recycling; Wall Oven(s); Multiple Ovens; Pantry; Walk-in Pantry; Granite Countertops; Kitchen Island <b>Master Bathroom:</b> Full Bth Master Bdrm; Separate Shwr & Tub; Double Sinks; Private Toilet Room; 2 Master Baths; Tub with Jets; Bidet <b>Master Bedroom:</b> Split; Downstairs <b>Additional Bedroom:</b> Other Bdrm Split; 2 Master Bdms; Separate Bdrm Exit; Mstr Bdr Walkin Clst; Othr Bdr Walkin Clst; Mstr Bdrm Sitting Rm <b>Laundry:</b> Inside Washer Included; Dryer Included; Inside <b>Dining Area:</b> Formal; Eat-in Kitchen; Breakfast Bar; Breakfast Room <b>Basement Y/N:</b> Y <b>Basement Description:</b> Walkout; Finished; Full <b>Sep Den/Office Y/N:</b> Y <b>Other Rooms:</b> Family Room; Great Room; Bonus/Game Room; Exercise/Sauna Room; Media Room <b>Items Updated:</b> Floor Yr Updated: 2021; Floor Partial/Full: Partial; Roof Yr Updated: 2017; Roof Partial/Full: Full	<b>Architecture:</b> Contemporary <b>Architect:</b> Gordon Rogers <b>Const - Finish:</b> Painted; Stucco; Stone <b>Construction:</b> Frame - Wood <b>Roofing:</b> Tile; Foam <b>Fencing:</b> Block <b>Cooling:</b> Refrigeration; Ceiling Fan(s) <b>Heating:</b> Electric <b>Utilities:</b> APS; SW Gas <b>Water:</b> City Water <b>Sewer:</b> Septic in & Cnctd <b>Services:</b> City Services <b>Technology:</b> Pre-Wire Srnd Snd; Cable TV Avail; High Speed Internet Available; Ntwrk Wrng Multi Rms; Security Sys Owned	<b>County Code:</b> Maricopa <b>Legal Description (Abbrev):</b> AN: 217-08-137 <b>Lot Number:</b> 34 <b>Town-Range-Section:</b> 4N-5E-16 <b>Cty Bk&amp;Pg:</b> Plat: <b>Taxes/Yr:</b> \$10,000/2010 <b>Ownership:</b> Fee Simple <b>New Financing:</b> Cash; VA; FHA; Conventional; 1031 Exchange <b>Total Asum Mnth Pmts:</b> \$0 <b>Down Payment:</b> \$0 <b>Existing 1st Loan:</b> Treat as Free&Clear <b>Existing 1st Ln Trms:</b> Disclosures: Seller Discl Avail; Agency Discl Req <b>Possession:</b> By Agreement; Close of Escrow

HOA Y/N: Y / \$3,766.73 / Semi-Annually	HOA Name: Los
HOA Transfer Fee: \$1,500	HOA Prop Man
HOA 2 Y/N: N / /	
HOA 3 Y/N: / /	
Association Fee Incl: Common Area Maint; Street Maint	
Remarks)	
Assoc Rules/Info: Pets OK (See Rmrks); Prof Managed	

Listing Dates	
CDOM/ADOM:	4 / 12
Status Change Date:	06/07/2022

**LOSTCANYONSCOTTSDALE.COM**

*more info, pictures, video tour*

**Denise van den Bossche**  
**602.980.0737. Denise@DeniseVDB.com**

**REALTY EXECUTIVES**  
**VAN DEN BOSSCHE**

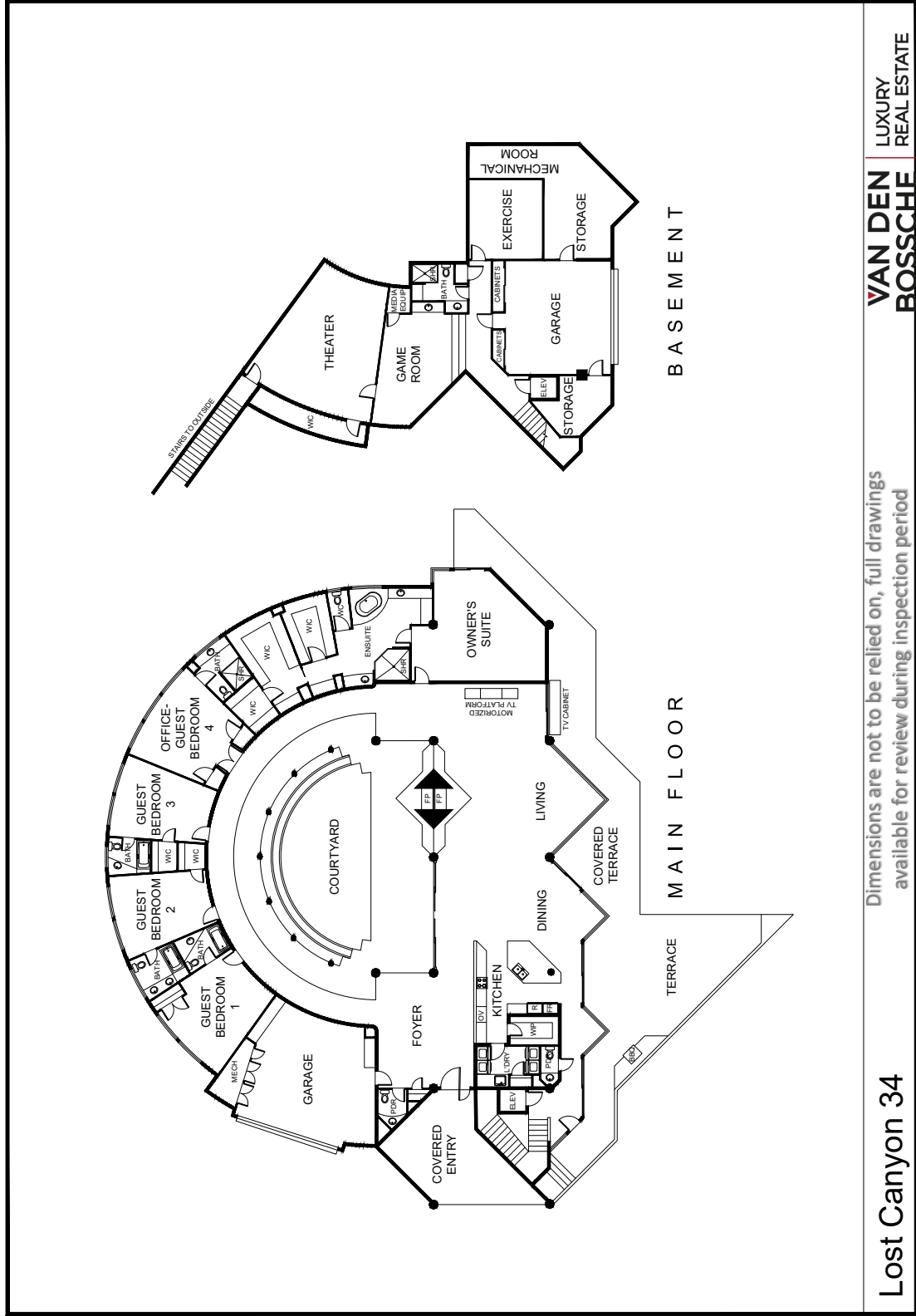

Dimensions are not to be relied on, full drawings  
available for review during inspection period

**VAN DEN BOSSCHE** LUXURY REAL ESTATE

Lost Canyon 34